







LEGENDA POŽÁRNÍCH ZNAČEK

-  EVAKUAČNÍ VÝTAH
-  NOUZOVÉ OSVĚTLENÍ
-  POŽÁRNÍ HLÁSIČ
-  SKŘÍŇ EL. ROZVADĚČŮ
S POŽ. DVÍŘKY EI 15-Sm DP1
-  PŘENOSNÝ HASICÍ
PŘÍSTROJ
-  SMĚR ÚNIKU / VÝCHOD
-  POŽÁRNĚ NEBEZPEČNÝ
PROSTOR

2.NP

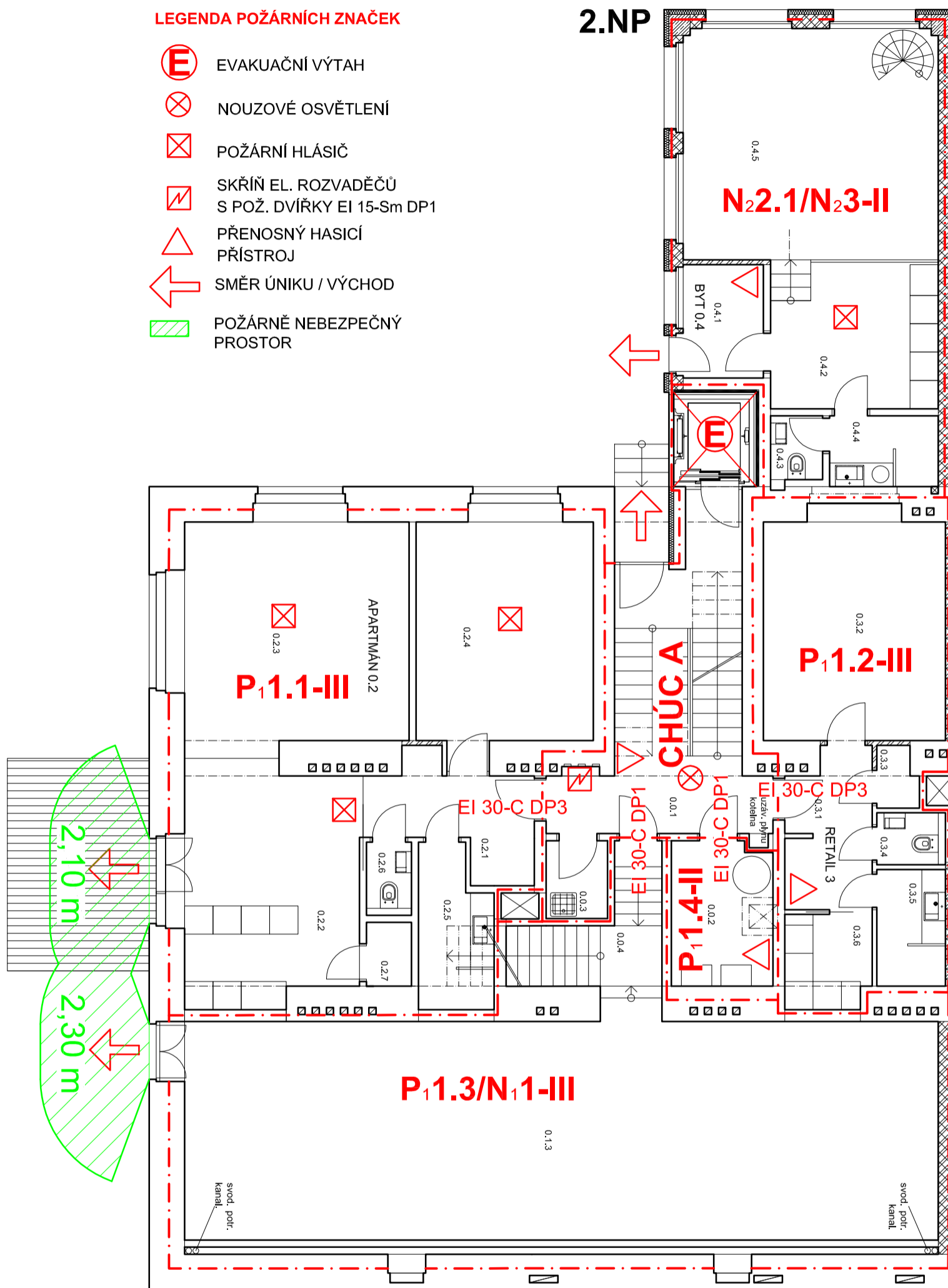

SEVER	
D.1.3 b3) M1:100	1.PP